

## NOTICE OF MEETING

# SPECIAL LICENSING SUB COMMITTEE

**Friday, 29th October, 2021, 2.00 pm - Remote Meeting - MS Teams**

**To watch, click [here](#)**

**Members:** Councillors Gina Adamou (Chair), Viv Ross and Sarah Williams

Quorum: 3

### **1. FILMING AT MEETINGS**

Please note this meeting may be filmed or recorded by the Council for live or subsequent broadcast via the Council's internet site or by anyone attending the meeting using any communication method. Members of the public participating in the meeting (e.g. making deputations, asking questions, making oral protests) should be aware that they are likely to be filmed, recorded or reported on. By entering the 'meeting room', you are consenting to being filmed and to the possible use of those images and sound recordings.

The Chair of the meeting has the discretion to terminate or suspend filming or recording, if in his or her opinion continuation of the filming, recording or reporting would disrupt or prejudice the proceedings, infringe the rights of any individual, or may lead to the breach of a legal obligation by the Council.

### **2. APOLOGIES FOR ABSENCE**

To receive any apologies for absence.

### **3. URGENT BUSINESS**

It being a special meeting of the Sub Committee, under Part Four, Section B, Paragraph 17, of the Council's Constitution, no other business shall be considered at the meeting.

### **4. DECLARATIONS OF INTEREST**

A member with a disclosable pecuniary interest or a prejudicial interest in a matter who attends a meeting of the authority at which the matter is considered:

- (i) must disclose the interest at the start of the meeting or when the interest becomes apparent, and
- (ii) may not participate in any discussion or vote on the matter and must withdraw from the meeting room.

A member who discloses at a meeting a disclosable pecuniary interest which is not registered in the Register of Members' Interests or the subject of a pending notification must notify the Monitoring Officer of the interest within 28 days of the disclosure.

Disclosable pecuniary interests, personal interests and prejudicial interests are defined at Paragraphs 5-7 and Appendix A of the Members' Code of Conduct.

## **5. SUMMARY OF PROCEDURE**

The Chair will explain the procedure that the Committee will follow for the hearing considered under the Licensing Act 2003.

## **6. APPLICATION FOR A VARIATION OF AN EXISTING PREMISES LICENCE AT OZ TOTTENHAM SUPERMARKET, 467-469 HIGH ROAD, LONDON, N17 (PAGES 1 - 36)**

To consider an application for a variation of an existing premises licence.

Fiona Rae, Principal Committee Co-ordinator

Tel – 020 8489 3541

Fax – 020 8881 5218

Email: [fiona.rae@haringey.gov.uk](mailto:fiona.rae@haringey.gov.uk)

Fiona Alderman

Head of Legal & Governance (Monitoring Officer)

River Park House, 225 High Road, Wood Green, N22 8HQ

Thursday, 21 October 2021

**Report for:** Licensing Sub Committee 29<sup>th</sup> October 2021

**Item number:**

**Title:** Application for a Variation of an existing Premises Licence – OZ Tottenham Supermarket, 467-469 High Road, Tottenham, London N17 6QA.

**Report authorised by :** Daliah Barrett-Licensing Team Leader – Regulatory Services.

**Ward(s) affected:** BG

**Report for Key/  
Non Key Decision:** Not applicable

**1. Describe the issue under consideration**

1.1 This report relates to an application for a new premises licence by Mr Mehmet Temur.

1.2 The application seeks the following:

**To remove**

Condition 17: The Premises shall not stock High strength beers in excess of 6.5%ABV and no single cans of alcohol are to be sold at the premises.

1.3 The application can be found at - **Appendix A.**

**1.4 Representations have been received from:**

**Responsible Authorities- Licensing Authority - App B**

**1.5 Recommendation**

In considering the representations received and what is appropriate for the promotion of the licensing objectives, the steps the Sub-Committee can take are:

- Grant the application as requested
- Grant the application whilst imposing additional conditions and/or altering in any way the proposed operating schedule.
- Exclude any licensable activities to which the application relates
- Reject the whole or part of the application

Members of the licensing sub committee are asked to note that they may not modify the conditions or reject the whole or part of the application merely because it considers it desirable to do so. It must be appropriate in order to promote the licensing objectives.

**2 Background**

2.1 The premises is situated along High Road Tottenham N17 at the junction with St Loys Road. The area has ongoing anti social behaviour from street drinkers that congregate in this location. The Premises has had previous problems with stocking illicit tobacco and alcohol. As a result the Trading Standards officer requested a Minor Variation was applied for in order for additional conditions to be added to the licence to promote the licensing objective of the prevention of crime disorder.

The area continues to have issues with street drinkers who are visible throughout the day and night in the location. The location is currently a point of focus for partnership working between the Regeneration Town Centre Manager, the Tottenham Safer Partnership and the Police to combat the problems associated with the street drinking and anti social behaviour taking place.

### 3 Licensing Policy

- 3.1 The committee will also wish to be aware of the guidance issued under section 182 of the Licensing Act 2003. Licensing is about regulating the provision of licensable activities on licensed premises, by qualifying clubs and at temporary events within the terms of the Licensing Act 2003. The terms and conditions attached to various permissions are focused on matters which are within the control of individual licensees and others granted relevant permissions. Accordingly, these matters will centre on the premises and places being used for licensable activities and the vicinity of those premises and places.
- 3.2 The objective of the licensing process is to allow for the carrying on of retail sales of alcohol and the prevention of public nuisance, prevention of crime and disorder, public safety and protection of children from harm. It is the Licensing Authority's wish to facilitate well run and managed premises with licence holders displaying sensitivity to the impact of the premises on local residents.
- 3.3 In considering licence applications, where relevant representations are made, this Licensing Authority will consider the adequacy of measures proposed to deal with the potential for public nuisance and/or public disorder having regard to all the circumstances of the case.
- 3.4 (19.15) Applications shall only be granted where the licensing authority is satisfied the grant of the licence would not harm the Licensing Objectives following a hearing. Where relevant representations are made, the licensing authority will also have particular consideration to the hours requested for sales of alcohol. Persons who are alcohol-dependant may be drawn to particular premises if they are licensed to sell alcohol at earlier or later times than other premises. Additionally, if there are issues related to late-night disorder, the hours for alcohol sales from the premises may be restricted. Other conditions may be imposed directed at avoiding problematic street drinking in the vicinity of the premises. Another particular concern will be irresponsible drink promotions that do not follow best practice, would appeal to underage drinkers or street drinkers, or encourage excessive consumption.
- 3.5 Where relevant representations are made, this authority will demand stricter conditions with regard to noise control in areas that have denser residential accommodation, but this will not limit opening hours without regard for the individual merits of any application. This authority will consider each application and work with the parties concerned to ensure that adequate noise control measures are in place. Any action taken to promote the licensing objectives will be appropriate and proportionate.
- 3.6 This Licensing Authority in determining what action to take will seek to establish the cause of concern and any action taken will be directed at these causes. Any action taken to promote the licensing objectives will be appropriate and proportionate.
- 3.7 Where relevant representations are made, this authority will demand stricter conditions with regard to noise control in areas that have denser residential accommodation, but this will not limit opening hours without regard for the

individual merits of any application. This authority will consider each application and work with the parties concerned to ensure that adequate noise control measures are in place

- 3.8 Also The Licensing Authority may not impose conditions unless its discretion has been exercised following receipt of relevant representations and it is satisfied as a result of the hearing that it is appropriate to impose conditions to promote one or more of the four licensing objectives. Therefore conditions may not be imposed for the purpose other than promoting the licensing objectives and in some cases no additional conditions will be required.
- 3.9 In cases Members should make their decisions on the civil burden of proof, that is the balance of probability.
- 3.10 Members should consider in all cases whether or not primary legislation is the appropriate method of regulation and should only consider licence conditions when the circumstances in their view are not already adequately covered elsewhere.
- 3.11 The Government has advised that conditions must be tailored to the individual type, location and characteristics of the premises and events concerned. Conditions cannot seek to manage the behaviour of customers once they are beyond the direct management of the licence holder and their staff.  
The Councils Licensing policy generally expects applicants to address the licensing objectives and discuss how to do this with the relevant responsible authorities.

#### 4 Licensing hours

- 4.2 Where relevant representations are made, the Council will consider the proposed hours on their individual merits. Notwithstanding this, the Council may require stricter conditions in areas that have denser residential accommodation to prevent public nuisance. The Council will endeavour to work with all parties concerned in such instances to ensure that adequate conditions are in place. The Council may restrict the hours that certain premises can offer alcohol for sale for consumption off the premises for preventing crime, disorder and nuisance.

#### 5 Powers of a Licensing Authority

- 5.1 The decision should be made with regard to the Secretary of the State's guidance and the Council's Statement of Licensing Policy under the Licensing Act 2003. Where the decision departs from either the Guidance or the Policy clear and cogent reasons must be given. Members should be aware that if such a departure is made the risk of appeal / challenge is increased.
- 5.2 The licensing authority's determination of this application is subject to a 21 day appeal period or if the decision is appealed the date of the appeal is determined and /or disposed of.

#### 6. Other considerations

**Section 17 of the Crime and Disorder Act 1998** states:

"Without prejudice to any other obligation imposed on it, it shall be the duty of each authority to which this section applies to exercise its various functions with due regard to the likely effect of the exercise of those function on, and the need to do all that it reasonably can to prevent crime and disorder in its area".

## 6.1 Human Rights

While all Convention Rights must be considered, those which are of particular relevance to the application are:

- Article 8 – Right to respect for private and family life.
- Article 1 of the First Protocol – Protection of Property
- Article 6(1) – Right to a fair hearing.
- Article 10 – Freedom of Expression

## 7 Use of Appendices

**Appendix A - New Application.**

**Appendix B – Responsible Authority Representations**

**Background papers: Section 82 Guidance**

**Haringey Statement of Licensing policy**

# Appendix A

This page is intentionally left blank





\* required information

## Section 1 of 18

You can save the form at any time and resume it later. You do not need to be logged in when you resume.

System reference

Not Currently In Use

This is the unique reference for this application generated by the system.

Your reference

Oz Tottenham Supermarket

You can put what you want here to help you track applications if you make lots of them. It is passed to the authority.

Are you an agent acting on behalf of the applicant?

☒ Yes ☐ No

Put "no" if you are applying on your own behalf or on behalf of a business you own or work for.

### Applicant Details

\* First name

Mr Mehmet

\* Family name

Temur

\* E-mail

ctemur1@hotmail.co.uk

Main telephone number

07904386535

Include country code.

Other telephone number

☐ Indicate here if the applicant would prefer not to be contacted by telephone

Is the applicant:

- ☒ Applying as a business or organisation, including as a sole trader  
☐ Applying as an individual

A sole trader is a business owned by one person without any special legal structure. Applying as an individual means the applicant is applying so the applicant can be employed, or for some other personal reason, such as following a hobby.

### Applicant Business

Is the applicant's business registered in the UK with Companies House?

☒ Yes ☐ No

Note: completing the Applicant Business section is optional in this form.

Registration number

12344723

Business name

OZ TOTTENHAM SUPERMARKET LIMITED

If the applicant's business is registered, use its registered name.

VAT number

-

Put "none" if the applicant is not registered for VAT.

Legal status

Private Limited Company

**Continued from previous page...**

Applicant's position in the business

Home country

The country where the applicant's headquarters are.

**Registered Address**

Address registered with Companies House.

Building number or name

Street

District

City or town

County or administrative area

Postcode

Country

**Agent Details**

\* First name

\* Family name

\* E-mail

Main telephone number

Include country code.

Other telephone number

☐ Indicate here if you would prefer not to be contacted by telephone

Are you:

- ☒ An agent that is a business or organisation, including a sole trader
- ☐ A private individual acting as an agent

A sole trader is a business owned by one person without any special legal structure.

**Agent Business**

Is your business registered in the UK with Companies House? ☒ Yes ☐ No

Note: completing the Applicant Business section is optional in this form.

Registration number

Business name

If your business is registered, use its registered name.

VAT number

Put "none" if you are not registered for VAT.

Legal status

*Continued from previous page...*Your position in the business Home country 

The country where the headquarters of your business is located.

**Agent Registered Address**

Address registered with Companies House.

Building number or name Street District City or town County or administrative area Postcode Country **Section 2 of 18****APPLICATION DETAILS**

**This application cannot be used to vary the licence so as to extend the period for which the licence has effect or to vary substantially the premises to which it relates. If you wish to make that type of change to the premises licence, you should make a new premises licence application under section 17 of the Licensing Act 2003.**

I/we, as named in section 1, being the premises licence holder, apply to vary a premises licence under section 34 of the Licensing Act 2003 for the premises described in section 2 below.

\* Premises Licence Number 

Are you able to provide a postal address, OS map reference or description of the premises?

☒ Address    ☐ OS map reference    ☐ Description
**Postal Address Of Premises**Building number or name Street District City or town County or administrative area Postcode Country **Premises Contact Details**Telephone number

*Continued from previous page...*Non-domestic rateable  
value of premises (£)

37,500

**Section 3 of 18****VARIATION**Do you want the proposed  
variation to have effect as  
soon as possible?☒ Yes☐ NoDo you want the proposed variation to have effect in relation to the  
introduction of the late night levy?☐ Yes☒ NoYou do not have to pay a fee if the only  
purpose of the variation for which you are  
applying is to avoid becoming liable to the  
late night levy.If your proposed variation  
would mean that 5,000 or  
more people are expected to  
attend the premises at any  
one time, state the number  
expected to attend**Describe Briefly The Nature Of The Proposed Variation**

Describe the premises. For example the type of premises, its general situation and layout and any other information which could be relevant to the licensing objectives. Where your application includes off-supplies of alcohol and you intend to provide a place for consumption of these off-supplies, you must include a description of where the place will be and its proximity to the premises.

Removal of condition 17: The Premises shall not stock High strength beers in excess of 6.5%ABV and no single cans of alcohol are to be sold at the premises.

**Section 4 of 18****PROVISION OF PLAYS**[See guidance on regulated entertainment](#)Will the schedule to provide plays be subject to change if this application to  
vary is successful?☐ Yes☒ No**Section 5 of 18****PROVISION OF FILMS**[See guidance on regulated entertainment](#)Will the schedule to provide films be subject to change if this application to  
vary is successful?☐ Yes☒ No**Section 6 of 18****PROVISION OF INDOOR SPORTING EVENTS**

*Continued from previous page...*[See guidance on regulated entertainment](#)

Will the schedule to provide indoor sporting events be subject to change if this application to vary is successful?

☐ Yes ☒ No

## Section 7 of 18

### PROVISION OF BOXING OR WRESTLING ENTERTAINMENTS

[See guidance on regulated entertainment](#)

Will the schedule to provide boxing or wrestling entertainments be subject to change if this application to vary is successful?

☐ Yes ☒ No

## Section 8 of 18

### PROVISION OF LIVE MUSIC

[See guidance on regulated entertainment](#)

Will the schedule to provide live music be subject to change if this application to vary is successful?

☐ Yes ☒ No

## Section 9 of 18

### PROVISION OF RECORDED MUSIC

[See guidance on regulated entertainment](#)

Will the schedule to provide recorded music be subject to change if this application to vary is successful?

☐ Yes ☒ No

## Section 10 of 18

### PROVISION OF PERFORMANCES OF DANCE

[See guidance on regulated entertainment](#)

Will the schedule to provide performances of dance be subject to change if this application to vary is successful?

☐ Yes ☒ No

## Section 11 of 18

### PROVISION OF ANYTHING OF A SIMILAR DESCRIPTION TO LIVE MUSIC, RECORDED MUSIC OR PERFORMANCES OF DANCE

[See guidance on regulated entertainment](#)

Will the schedule to provide anything similar to live music, recorded music or performances of dance be subject to change if this application to vary is successful?

☐ Yes ☒ No

## Section 12 of 18

### PROVISION OF LATE NIGHT REFRESHMENT

*Continued from previous page...*

Will the schedule to provide late night refreshment be subject to change if this application to vary is successful?

☐ Yes ☒ No

### Section 13 of 18

#### SUPPLY OF ALCOHOL

Will the schedule to supply alcohol be subject to change if this application to vary is successful?

☒ Yes ☐ No

#### Standard Days And Timings

##### MONDAY

Start

End

Start

End

Provide timings in 24 hour clock (e.g., 16:00) and only give details for the days of the week when you intend the premises to be used for the activity.

##### TUESDAY

Start

End

Start

End

##### WEDNESDAY

Start

End

Start

End

##### THURSDAY

Start

End

Start

End

##### FRIDAY

Start

End

Start

End

##### SATURDAY

Start

End

Start

End

##### SUNDAY

Start

End

Start

End

*Continued from previous page...*

Will the sale of alcohol be for consumption?

☐ On the premises      ☒ Off the premises      ☐ Both

If the sale of alcohol is for consumption on the premises select on, if the sale of alcohol is for consumption away from the premises select off. If the sale of alcohol is for consumption on the premises and away from the premises select both.

State any seasonal variations.

For example (but not exclusively) where the activity will occur on additional days during the summer months.

N/A

Non-standard timings. Where the premises will be used for the supply of alcohol at different times from those listed above, list below.

For example (but not exclusively), where you wish the activity to go on longer on a particular day e.g. Christmas Eve.

N/A

## Section 14 of 18

### ADULT ENTERTAINMENT

Highlight any adult entertainment or services, activities, or other entertainment or matters ancillary to the use of the premises that may give rise to concern in respect of children.

Provide information about anything intended to occur at the premises or ancillary to the use of the premises which may give rise to concern in respect of children, regardless of whether you intend children to have access to the premises, for example (but not exclusively) nudity or semi-nudity, films for restricted age groups etc gambling machines etc.

N/A

## Section 15 of 18

### HOURS PREMISES ARE OPEN TO THE PUBLIC

#### Standard Days And Timings

MONDAY

Start

End

Start

End

Provide timings in 24 hour clock (e.g., 16:00) and only give details for the days of the week when you intend the premises to be used for the activity.

TUESDAY

Start

End

Start

End

*Continued from previous page...*

WEDNESDAY

Start	<input type="text" value="00:00"/>	End	<input type="text" value="00:00"/>
Start	<input type="text"/>	End	<input type="text"/>

THURSDAY

Start	<input type="text" value="00:00"/>	End	<input type="text" value="00:00"/>
Start	<input type="text"/>	End	<input type="text"/>

FRIDAY

Start	<input type="text" value="00:00"/>	End	<input type="text" value="00:00"/>
Start	<input type="text"/>	End	<input type="text"/>

SATURDAY

Start	<input type="text" value="00:00"/>	End	<input type="text" value="00:00"/>
Start	<input type="text"/>	End	<input type="text"/>

SUNDAY

Start	<input type="text" value="00:00"/>	End	<input type="text" value="00:00"/>
Start	<input type="text"/>	End	<input type="text"/>

State any seasonal variations.

For example (but not exclusively) where the activity will occur on additional days during the summer months.

N/A

Non standard timings. Where you intend to use the premises to be open to the members and guests at different times from those listed above, list below.

For example (but not exclusively), where you wish the activity to go on longer on a particular day e.g. Christmas Eve.

N/A

Identify those conditions currently imposed on the licence which you believe could be removed as a consequence of the proposed variation you are seeking.

Condition no 17: The Premises shall not stock High strength beers in excess of 6.5%ABV and no single cans of alcohol are to be sold at the premises.

☒ I have enclosed the premises licence



*Continued from previous page...*

☐ I have enclosed the relevant part of the premises licence

Reasons why I have failed to enclose the premises licence or relevant part of premises licence.

## Section 16 of 18

### LICENSING OBJECTIVES

Describe the steps you intend to take to promote the four licensing objectives:

a) General – all four licensing objectives (b,c,d,e)

List here steps you will take to promote all four licensing objectives together.

All the other conditions will remain as it is. The application is to remove Condition no 17: The Premises shall not stock High strength beers in excess of 6.5%ABV and no single cans of alcohol are to be sold at the premises.

b) The prevention of crime and disorder

c) Public safety

d) The prevention of public nuisance

e) The protection of children from harm

## Section 17 of 18

### NOTES ON REGULATED ENTERTAINMENT

*Continued from previous page...*

In terms of specific **regulated entertainments** please note that:

- Plays: no licence is required for performances between 08:00 and 23.00 on any day, provided that the audience does not exceed 500.
- Films: no licence is required for 'not-for-profit' film exhibition held in community premises between 08.00 and 23.00 on any day provided that the audience does not exceed 500 and the organiser (a) gets consent to the screening from a person who is responsible for the premises; and (b) ensures that each such screening abides by age classification ratings.
- Indoor sporting events: no licence is required for performances between 08.00 and 23.00 on any day, provided that the audience does not exceed 1000.
- Boxing or Wrestling Entertainment: no licence is required for a contest, exhibition or display of Greco-Roman wrestling, or freestyle wrestling between 08.00 and 23.00 on any day, provided that the audience does not exceed 1000. Combined fighting sports – defined as a contest, exhibition or display which combines boxing or wrestling with one or more martial arts – are licensable as a boxing or wrestling entertainment rather than an indoor sporting event.
- Live music: no licence permission is required for:
  - o a performance of unamplified live music between 08.00 and 23.00 on any day, on any premises.
  - o a performance of amplified live music between 08.00 and 23.00 on any day on premises authorised to sell alcohol for consumption on those premises, provided that the audience does not exceed 500.
  - o a performance of amplified live music between 08.00 and 23.00 on any day, in a workplace that is not licensed to sell alcohol on those premises, provided that the audience does not exceed 500.
  - o a performance of amplified live music between 08.00 and 23.00 on any day, in a church hall, village hall, community hall, or other similar community premises, that is not licensed by a premises licence to sell alcohol, provided that (a) the audience does not exceed 500, and (b) the organiser gets consent for the performance from a person who is responsible for the premises.
  - o a performance of amplified live music between 08.00 and 23.00 on any day, at the non-residential premises of (i) a local authority, or (ii) a school, or (iii) a hospital, provided that (a) the audience does not exceed 500, and (b) the organiser gets consent for the performance on the relevant premises from: (i) the local authority concerned, or (ii) the school or (iii) the health care provider for the hospital.
- Recorded Music: no licence permission is required for:
  - o any playing of recorded music between 08.00 and 23.00 on any day on premises authorised to sell alcohol for consumption on those premises, provided that the audience does not exceed 500.
  - o any playing of recorded music between 08.00 and 23.00 on any day, in a church hall, village hall, community hall, or other similar community premises, that is not licensed by a premises licence to sell alcohol, provided that (a) the audience does not exceed 500, and (b) the organiser gets consent for the performance from a person who is responsible for the premises.
  - o any playing of recorded music between 08.00 and 23.00 on any day, at the non-residential premises of (i) a local authority, or (ii) a school, or (iii) a hospital, provided that (a) the audience does not exceed 500, and (b) the organiser gets consent for the performance on the relevant premises from: (i) the local authority concerned, or (ii) the school proprietor or (iii) the health care provider for the hospital.

**Continued from previous page...**

- Dance: no licence is required for performances between 08.00 and 23.00 on any day, provided that the audience does not exceed 500. However, a performance which amounts to adult entertainment remains licensable.
- Cross activity exemptions: no licence is required between 08.00 and 23.00 on any day, with no limit on audience size for:
  - o any entertainment taking place on the premises of the local authority where the entertainment is provided by or on behalf of the local authority;
  - o any entertainment taking place on the hospital premises of the health care provider where the entertainment is provided by or on behalf of the health care provider;
  - o any entertainment taking place on the premises of the school where the entertainment is provided by or on behalf of the school proprietor; and
  - o any entertainment (excluding films and a boxing or wrestling entertainment) taking place at a travelling circus, provided that (a) it takes place within a moveable structure that accommodates the audience, and (b) that the travelling circus has not been located on the same site for more than 28 consecutive days.

**Section 18 of 18****PAYMENT DETAILS**

This fee must be paid to the authority. If you complete the application online, you must pay it by debit or credit card.

Variation Fees are determined by the non domestic rateable value of the premises.

To find out a premises non domestic rateable value go to the Valuation Office Agency site at [http://www.voa.gov.uk/business\\_rates/index.htm](http://www.voa.gov.uk/business_rates/index.htm)

Band A - No RV to £4300	£100.00
Band B - £4301 to £33000	£190.00
Band C - £33001 to £8700	£315.00
Band D - £87001 to £12500	£450.00*
Band E - £125001 and over	£635.00*

\*If the premises rateable value is in Bands D or E and the premises is primarily used for the consumption of alcohol on the premises then your are required to pay a higher fee

Band D - £87001 to £12500	£900.00
Band E - £125001 and over	£1,905.00

If you own a large premise you are subject to additional fees based upon the number in attendance at any one time

Capacity 5000-9999	£1,000.00
Capacity 10000 -14999	£2,000.00
Capacity 15000-19999	£4,000.00
Capacity 20000-29999	£8,000.00
Capacity 30000-39000	£16,000.00
Capacity 40000-49999	£24,000.00
Capacity 50000-59999	£32,000.00
Capacity 60000-69999	£40,000.00
Capacity 70000-79999	£48,000.00
Capacity 80000-89999	£56,000.00
Capacity 90000 and over	£64,000.00

The following credit or debit cards are accepted in Haringey:

Maestro - Mastercard Debit - Mastercard Credit - Solo - Visa Credit - Visa Debit (formerly Delta) and Visa Electron

We cannot accept liability if payment is refused or declined by the card supplier.

Due to end of day processing, this service will not be available between 10pm and 11pm every weekday evening (Mon- Fri).

*Continued from previous page...*

Users should note that any payments in process after the 10pm deadline need to be completed by 10.05pm

\* Fee amount (£)

315.00

## DECLARATION

\* I/we understand it is an offence, liable on conviction to a fine up to level 5 on the standard scale, under section 158 of the licensing act 2003, to make a false statement in or in connection with this application.

☐

Ticking this box indicates you have read and understood the above declaration

This section should be completed by the applicant, unless you answered "Yes" to the question "Are you an agent acting on behalf of the applicant?"

\* Full name

Mrs Aysen Ipek Kilic

\* Capacity

Licensing Consultant

\* Date

06

/

09

/

2021

dd

mm

yyyy

Add another signatory

Once you're finished you need to do the following:

1. Save this form to your computer by clicking file/save as...
2. Go back to <https://www.gov.uk/apply-for-a-licence/premises-licence/haringey/change-1> to upload this file and continue with your application.

Don't forget to make sure you have all your supporting documentation to hand.

**IT IS AN OFFENCE, UNDER SECTION 158 OF THE LICENSING ACT 2003, TO MAKE A FALSE STATEMENT IN OR IN CONNECTION WITH THIS APPLICATION. THOSE WHO MAKE A FALSE STATEMENT MAY BE LIABLE ON SUMMARY CONVICTION TO A FINE OF ANY AMOUNT.**

OFFICE USE ONLY	
Applicant reference number	<input type="text" value="Oz Tottenham Supermarket"/>
Fee paid	<input type="text"/>
Payment provider reference	<input type="text"/>
ELMS Payment Reference	<input type="text"/>
Payment status	<input type="text"/>
Payment authorisation code	<input type="text"/>
Payment authorisation date	<input type="text"/>
Date and time submitted	<input type="text"/>
Approval deadline	<input type="text"/>
Error message	<input type="text"/>
Is Digitally signed	<input type="checkbox"/>

[1](#) [2](#) [3](#) [4](#) [5](#) [6](#) [7](#) [8](#) [9](#) [10](#) [11](#) [12](#) [13](#) [14](#) [15](#) [16](#) [17](#) [18](#) [Next >](#)

This page is intentionally left blank

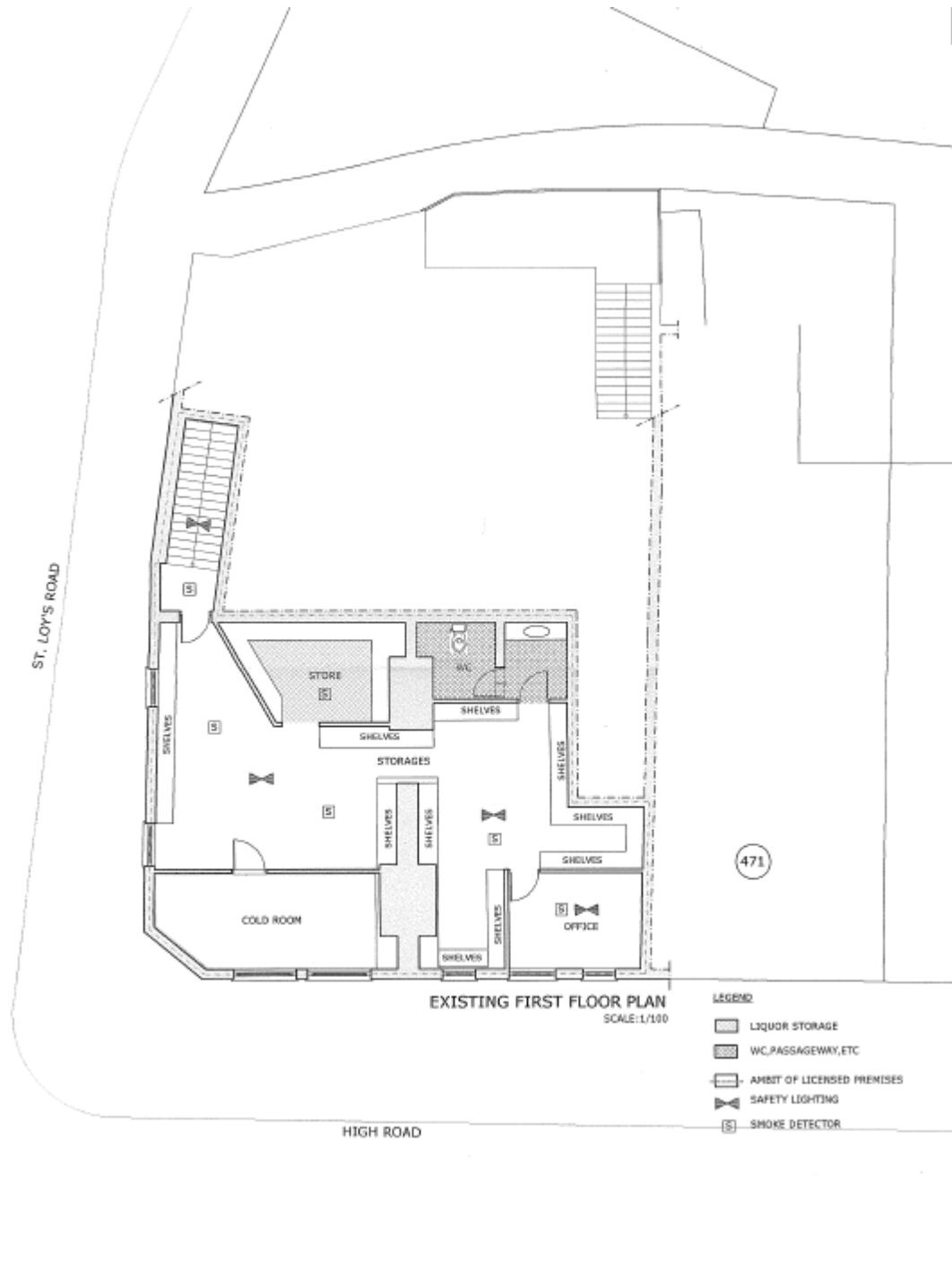

This page is intentionally left blank



**PREMISES LICENCE****Receipt:** AG754130 & F00110029069**Premises Licence Number:** LN/00001230  
LN/000003052*This Premises Licence has been issued by:****The Licensing Authority, London Borough of Haringey,  
1<sup>st</sup> Floor-North, River Park House, 225 High Road,  
Wood Green, London N22 8HQ*****Signature:** .....**Date:** 24<sup>th</sup> November 2005  
Vary DPS: 14<sup>th</sup> August 2021**Part 1 – PREMISES DETAILS****Postal Address of Premises or, if none, Ordnance Survey map reference or description:****OZ TOTTENHAM SUPERMARKET  
467- 469 HIGH ROAD  
TOTTENHAM  
LONDON  
N17 6QA**

Telephone: 0208 808 9028

**Where the Licence is time limited, the dates:**

Not applicable

**Licensable activities authorised by the Licence:****Supply of Alcohol****The times the Licence authorises the carrying out of licensable activities:****Supply of Alcohol****Monday to Sunday            0000 to 0000****The opening hours of the premises:****Supply of Alcohol****Monday to Sunday            0000 to 0000****Where the Licence authorises supplies of alcohol whether these are on and/or off supplies:**Supply of alcohol for consumption **OFF** the premises.

**Part 2**

**Name, (registered) address, telephone number and e-mail (where relevant) of holder of Premises Licence:**

Oz Tottenham Supermarket Limited  
467-469 High Road  
Tottenham  
London  
N17 6QA

**Registered number of holder, for example company number, charity number (where applicable):**

12344723

**Name, address and telephone number of designated premises supervisor where the Premises Licence authorises the supply of alcohol:**

Mehmet Temur  
327 Lordship Lane  
London  
N17 6AB

**Personal Licence number and issuing authority of personal licence held by designated premises supervisor where the Premises Licence authorises for the supply of alcohol:**

Personal Licence:	LN/000023666
Issued By:	London Borough of Haringey

## Annex 1 –Mandatory Conditions

No supply of alcohol may be made under the premises licence -

- a) at a time when there is no designated premises supervisor in respect of the premises licence, or
- b) at a time when the designated premises supervisor does not hold a personal licence or his personal licence is suspended.

Every supply of alcohol under the premises licence must be made or authorised by a person who holds a personal licence.

The premises licence holder or club premises certificate holder shall ensure that an age verification policy applies to the premises in relation to the sale or supply of alcohol. The policy must require individuals who appear to the responsible person to be under 18 years of age (or such older age as may be specified in the policy) to produce on request, before being served alcohol, identification bearing their photograph, date of birth and a holographic mark.

A relevant person shall ensure that no alcohol is sold or supplied for consumption on or off the premises for a price which is less than the permitted price.

### Minimum Drinks Pricing

1. A relevant person shall ensure that no alcohol is sold or supplied for consumption on or off the premises for a price which is less than the permitted price.

2. For the purposes of the condition set out in paragraph 1 –

(a) “duty” is to be construed in accordance with the Alcoholic Liquor Duties Act 1979

(b) “permitted price” is the price found by applying the formula –

$$P = D + (D \times V)$$

Where –

- (i) P is the permitted price
- (ii) D is the amount of duty chargeable in relation to the alcohol as if the duty were charged on the date of the sale or supply of the alcohol, and
- (iii) V is the rate of value added tax chargeable in relation to the alcohol as if the value added tax were charged on the date of the sale or supply of the alcohol;
- (c) “relevant person” means, in relation to premises in respect of which there is in force a premises licence –
  - (i) The holder of the premises licence
  - (ii) The designated premises supervisor (if any) in respect of such a licence, or
  - (iii) The personal licence holder who makes or authorises a supply of alcohol under such a licence;
- (d) “relevant person” means, in relation to premises in respect of which there is in force a club premises certificate, any member or officer of the club present on the premises in a capacity which enables the member or officer to prevent the supply in question; and
- (e) “value added tax” means value added tax charged in accordance with the Value Added Tax Act 1994.

**Annex 1 –Mandatory Conditions**

3. Where the permitted price given by Paragraph (b) of paragraph 2 would (apart from the paragraph) not be a whole number of pennies, the price given by that sub-paragraph shall be taken to be the price actually given by that sub-paragraph rounded up to the nearest penny.
4. (1) Sub-paragraph (2) applies where the permitted price given by Paragraph (b) of paragraph 2 on a day (“the first day”) would be different from the permitted price on the next day (“the second day”) as a result of a change to the rate of duty or value added tax.  
  
(2) The permitted price which would apply on the first day applies to sales or supplies of alcohol which take place before the expiry of the period of 14 days beginning on the second day.

## **Annex 2 – Conditions consistent with the Operating Schedule**

### **THE PREVENTION OF CRIME AND DISORDER**

- CCTV to be maintained on premises.
- Police linked panic button on the premises.
- Four staff will be located within the property at any given time.

### **PUBLIC SAFETY**

- Adequate arrangements are in place at the premises to warn persons in the event of a fire, there is emergency lighting, fire exits and relevant signage on the premises.

### **THE PREVENTION OF PUBLIC NUISANCE**

- The premise has adequate arrangements for the safe storage and regular removal of refuse.

### **THE PROTECTION OF CHILDREN**

- Photographic evidence is required as proof of age from persons appearing to be under the age of 18 and attempting to purchase alcohol.

**Annex 3 – Conditions attached after a hearing by the licensing authority**

**THE Highbury Corner Magistrates' Court  
23 October 2020**

**MAGISTRATES DECISION**

1. The business shall adopt a "Challenge 25" policy
2. A refusals register shall be maintained to record instances where alcohol sales are refused. These records shall be made available for inspection by Police and Authorised Council officers on request.
3. All staff responsible for selling alcohol shall receive regular training in the requirements of the Licensing Act 2003 and all other age restricted products stocked on the premises. Written records of this training signed and dated by the person receiving the training and the trainer shall be retained and made available to Police and authorised council officers on request.
4. Posters shall be displayed in prominent positions around the till advising customers of the "proof of age" required under the "Challenge 25" policy at the premises. Only Employees of the business who have been formally trained on Licensing requirements and age restricted sales may serve behind the counter.
5. A refusals book shall be kept at the premises to record details of all refusals to sell alcohol and age restricted products. This book shall contain:
  - The date and time of the incident,
  - The product which was the subject of the refusal
  - A description of the customer,
  - The name of the staff member who refused the sale
  - The reason the sale was refused.
  - This book shall be made available to Police and all authorised council officers on request.
6. The Designated Premises Supervisor shall regularly check the refusals book to ensure it is being consistently used by all staff. They shall sign and date when inspected.
7. The Premises Licence Holder and Designated Premises Licence Holder shall ensure alcohol is only purchased from a wholesaler registered with HMRC under the Alcohol Wholesaler Registration Scheme (AWRS).and shall produce receipts for the same upon request for inspection.
8. The Premises Licence Holder and Designated Premises Supervisor shall ensure persons responsible for purchasing alcohol do not take part in any stock swaps or lend or borrow any alcohol goods from any other source unless the source is another venue owned and operated by the same company who also purchase their stock from an authorised wholesaler.
9. The Premises Licence Holder shall ensure all receipts for alcohol goods purchased include the following details:
  - i. Seller's name and address
  - ii. Seller's company details, if applicable
  - iii. Seller's VAT details, if applicable

**Annex 3 – Conditions attached after a hearing by the licensing authority**

- iv. AWRS registration number
- v. Vehicle registration detail, if applicable

Legible copies of receipts for alcohol purchases shall be retained on the premises for twelve months and made available to Authorised Officers on request.

10. An ultra-violet light shall be purchased and used at the store to check the authenticity of all stock purchased which bears a UK Duty Paid stamp.
11. Where the trader becomes aware that any alcohol may be not duty paid they shall inform the Council of this immediately. Only alcohol and tobacco which is available for retail sale shall be stored at the licensed premises.
12. All tobacco products which are not on the covered tobacco display cabinet shall be stored in a container clearly marked 'Tobacco Stock'. This container shall be kept within the store room or behind the sales counter.
13. Tobacco shall only be taken from the covered tobacco display cabinet behind the sales counter in order to make a sale.
14. After evidence of any legal non-compliance relevant to the promotion of the Licensing Objectives is found, the licensee shall attend a meeting, upon reasonable request, with appropriate Responsible Authorities at the Council Offices or other suitable location. This condition does not require the licensee to say anything while under caution.
15. A CCTV system should be installed and kept in working order. It should be able to record colour footage for a period of 31 days and be able to capture clear video of persons faces and shoulders when they enter the premises and cover the area of the sales counter. These images should be able to be loaded onto disc or other electronic media should a police Officer or Authorized Council Officer require a copy. Where copies of recordings are requested they should be provided in a reasonable time and in a format which can be viewed without specialist software.
16. All Staff left in charge of the premises should be trained in the operation of CCTV and the production of copies of recordings
17. The Premises shall not stock High strength beers in excess of 6.5%ABV and no single cans of alcohol are to be sold at the premises.

Annex 4 – Plans

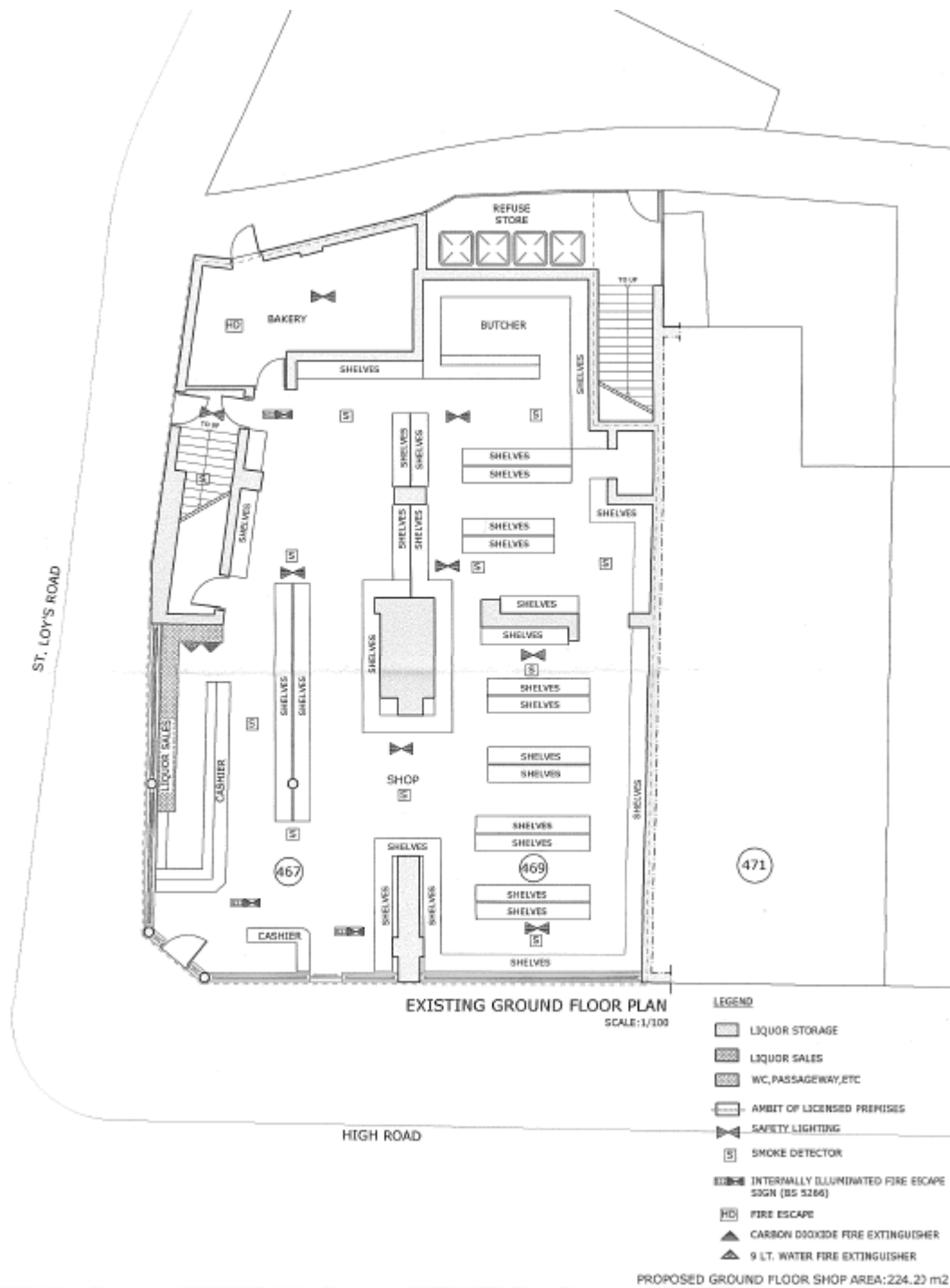



Annex 4 – Plans

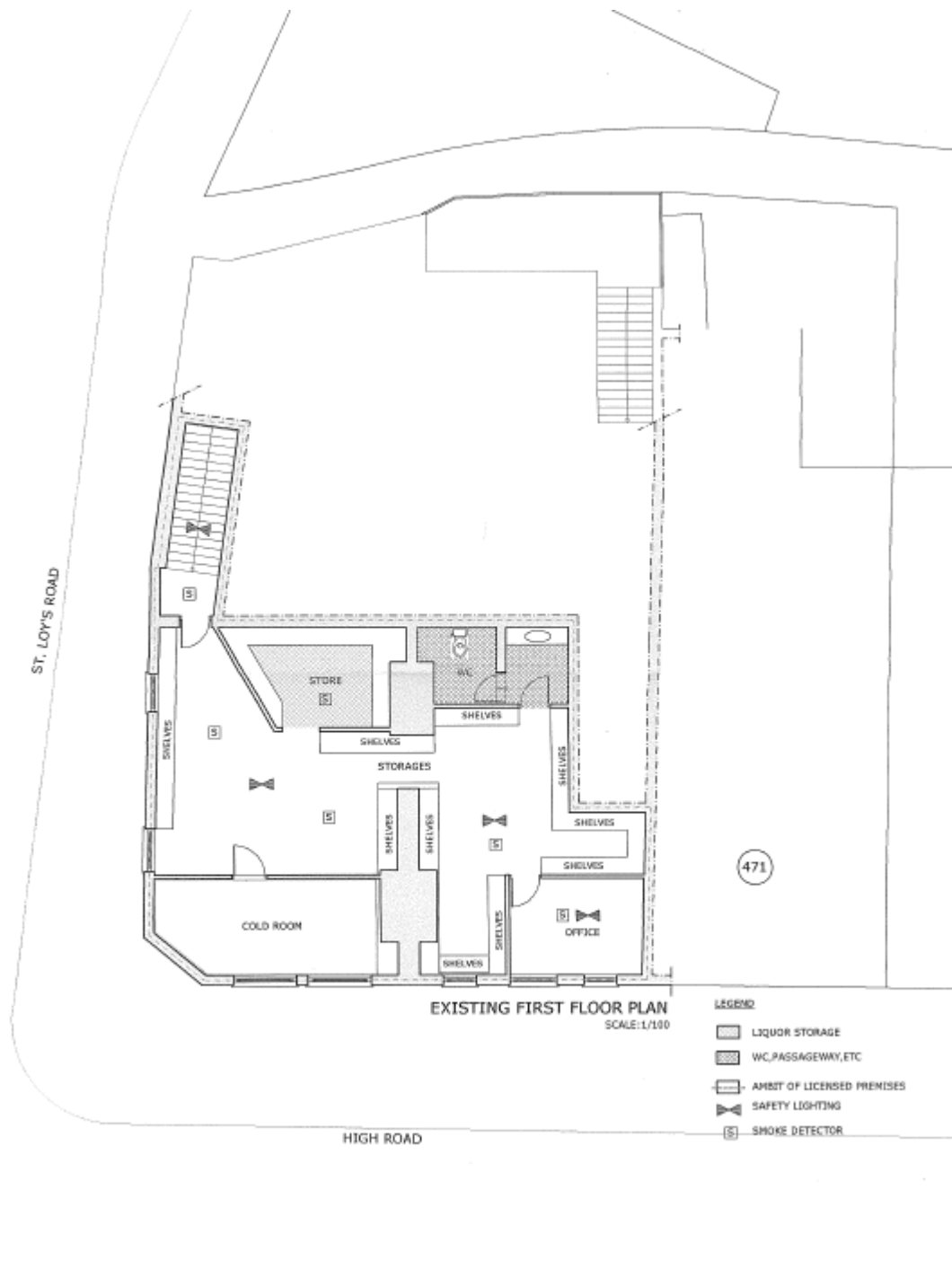

This page is intentionally left blank

# Appendix B

This page is intentionally left blank

Your Ref:

Our Ref:

Date: 17<sup>th</sup> September 2021

NARTS.

BY EMAIL

## REPRESENTATION LETTER

Dear Sir/Madam,

**LICENSING ACT 2003 – Application for a Variation to an existing Premises Licence- OZ Tottenham Supermarket, 467-469 High Road, Tottenham, London N17 6QA.**

The application seeks the removal of conditions that were placed on the licence due to the problems associated in the area with street drinking and its effects on the community.

Anti-social drinking in the streets can intimidate members of the public, cause disorder and nuisance, and generally degrade a public space. This can range from groups of street drinkers, to general drunken or rowdy behaviour as part of the day to day 'culture' of the shopping area.

The impact of anti-social drinking causes crime and anti-social behaviour linked to alcohol misuse. Alcohol misuse shows strong links to violence.

Street drinking can be perceived as intimidating by others. Alcohol misuse is linked to disorder and contributes to an increase in people's fear of crime; there is a perception that alcohol-related violence on the streets is increasing, and some members of the public see drinking on the street as a problem. Many people are therefore less, rather than more, likely to want to spend time in an area that is perceived to have such issues linked to alcohol misuse.

Where someone is causing alarm and distress through their drunken behaviour, it may be necessary to protect the community, one of the ways that business seeking to sell alcohol in areas affected by this behaviour is to ensure that reasonable and proportionate conditions are placed on Premises licence, thereby ensuring that measures are in place to adequately uphold and promote the licensing objectives.

Essentially, the anti social behaviour situation is taking place and in the immediate vicinity to this location. We understand that the Town centre Manager has engaged with Mr Temur due to these matters. We understand that Mr Temur has agreed to complete an ASB audit for the BCRP (Borough Crime Reduction Partnership) in order to help inform the problems arising and thereby enable a targeted response to the matters raised.

We are pleased that Mr Temur has shown an interest to join the BCRP and become an active member of such. In doing so he will participate by reporting any crime and therefore helping to reduce the problem.

To this end we cannot support the removal of the conditions and are proposing the following wording to the conditions as well as a further condition to be added to the licence:

- Beers, lagers, stout and ciders sold at the premises should not exceed 6.5% alcohol volume.
- No single cans of beers lagers, stout and ciders are to be sold at the premises.
- No miniature bottles of spirits to be sold

**Licensing Enforcement Officer  
LA Responsible Authority.**